

Milling Tools / Cutters for counter-matrix made of Perlinax and Steel, for engraving brass, for milling wood.

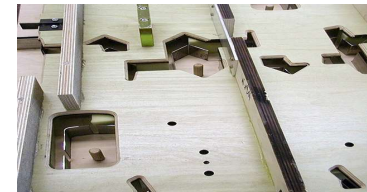

Milling of creasing channels on steel plates form 35 HRC to 52 HRC

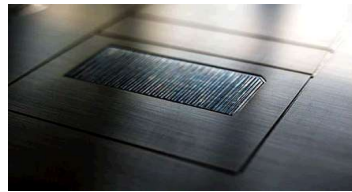
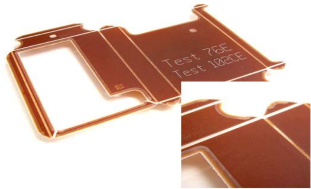
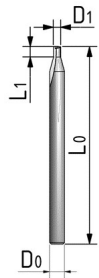

Art.#	Description	D0	L0	L1	W1	D1 Cutting-Ø	Material
SDA0010	Cutters, double edge	3	40	1,2		1,00	TC + TiAIN
SDA0011	This tools were specially developed for milling/	3	40	1,2		1,10	TC + TiAIN
SDA0012	engraving the creasing channel in a steel plate	3	40	1,2		1,20	TC + TiAIN
SDA0013	They represent the best	3	40	1,2		1,30	TC + TiAIN
SDA0014	cutting-life: price ratio.	3	40	1,4		1,40	TC + TiAIN
SDA0015		3	40	1,4		1,50	TC + TiAIN
SDA0016		3	40	1,4		1,60	TC + TiAIN
SDA0017	(revolutions/speed/torque) and depending on the	3	40	1,4		1,70	TC + TiAIN
SDA0018	cooling system	3	40	1,5		1,80	TC + TiAIN
SDA0019	TC (tungsten carbide) coated with TiAIN	3	40	1,5		1,90	TC + TiAIN
SDA0020		3	40	1,8		2,00	TC + TiAIN
SDA0021		3	40	5		2,10	TC + TiAIN
SDD0022		3	40	5		2,20	TC + TiAIN
SDD0023		3	40	5		2,30	TC + TiAIN

Milling of creasing channels on steel plates form 35 HRC to 52 HRC

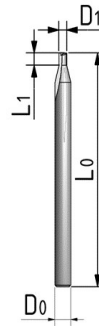

Art.#	Description	D0	L0	L1	W1	D1 Cutting-Ø	Material
SDD0010	Cutters, double edge	3	40	1,2		1,00	TC + AlTin-S
SDD0011	This tools were specially developed for milling/engraving the	3	40	1,2		1,10	TC + AlTin-S
SDD0012	creasing channel in a steel plate.	3	40	1,2		1,20	TC + AlTin-S
SDD0013	You can cut in steps of 0.05 or 0.10 mm, according to the	3	40	1,2		1,30	TC + AlTin-S
SDD0014	hardness and constitution of the material, cutting parameters	3	40	1,4		1,40	TC + AlTin-S
SDD0015	(revolutions/speed/torque) and depending on cooling system	3	40	1,4		1,50	TC + AlTin-S
SDD0016	TC (tungsten carbide) cotaed with AlTin-S	3	40	1,4		1,60	TC + AlTin-S
SDD0017		3	40	1,4		1,70	TC + AlTin-S
SDD0018		3	40	1,5		1,80	TC + AlTin-S
SDD0019		3	40	1,5		1,90	TC + AlTin-S
SDD0020		3	40	1,8		2,00	TC + AlTin-S
SDD0021		3	40	5		2,10	TC + AlTin-S
SDD0022		3	40	5		2,20	TC + AlTin-S

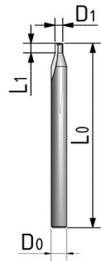

Milling of creasing channels on steel plates form 35 HRC to 52 HRC

Art.#	Description	D0	L0	L1	W1	D1 Cutting-Ø	Coated
SDE0009	Cutters, double edge	3	38			0,90	TC + AlCrN
SDE0010	This tools were specially developed for milling/engraving the	3	38			1,00	TC + AlCrN
SDE0011	creasing channel in a steel plate.	3	38			1,10	TC + AlCrN
SDE0012	You can cut in steps of 0.10 mm, according to the	3	38			1,20	TC + AlCrN
SDE0013	hardness and constitution of the material, cutting parameters	3	38			1,30	TC + AlCrN
SDE0014	(revolutions/speed/torque) and depending on the cooling	3	38			1,40	TC + AlCrN
SDE0015	system	3	38			1,50	TC + AlCrN
SDE0016		3	38			1,60	TC + AlCrN

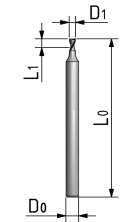

Milling of creasing channels on steel plates form 35 HRC to 52 HRC

Art.#	Description	D0	L0	L1	W1	D1 Cutting-Ø	Material
SDH0011	Cutters, double edge	3	40			1,10	TC + AlTiCrN
SDH0012	TC (tungsten carbide) coated with AlTiCrN , which last longer	3	40			1,20	TC + AlTiCrN
SDH0013	Life-time > 200 m at V=2 m/min.	3	40			1,30	TC + AlTiCrN
SDH0014		3	40			1,40	TC + AlTiCrN
SDH0015		3	40			1,50	TC + AlTiCrN
SDH0016		3	40			1,60	TC + AlTiCrN
SDH0017		3	40			1,70	TC + AlTiCrN
SDH0018		3	40			1,80	TC + AlTiCrN
SDH0019		3	40			1,90	TC + AlTiCrN

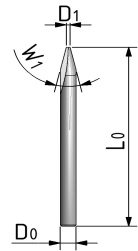

SDF0010	CONICAL Cutters, single edge, conical (25°)	3	38/40		25°	1,00	TC + AlTiCrN
SDF0011	For cutting a conical (tapered) channel on steel plates	3	38		25°	1,10	TC + AlTiCrN
SDF0012	Ideal for creasing cardboard laminated with PET / OPP on the	3	38		25°	1,20	TC + AlTiCrN
SDF0013	inner side, also good to use with facet creasing rules and	3	38		25°	1,30	TC + AlTiCrN
SDF0014	when the creasing rule is higher than the cutting rule	3	38		25°	1,40	TC + AlTiCrN
SDF0022		3	38		25°	2,20	TC + AlTiCrN
SDF0023		3	38		25°	2,30	TC + AlTiCrN
SDF0024		3	38		25°	2,40	TC + AlTiCrN

SDG0010	CONICAL Cutters, single edge, conical (15°)	3	40		15°	1,00	TC + AlTiCrN
SDG0011		3	40		15°	1,10	TC + AlTiCrN
SDG0012		3	40		15°	1,20	TC + AlTiCrN
SDG0013		3	40		15°	1,30	TC + AlTiCrN
SDG0014		3	40		15°	1,40	TC + AlTiCrN
SDG0016		3	40		15°	1,50	TC + AlTiCrN

**NEW
NEW**

SDL0010	CUATRO , special cutter with 4 bevels to cut faster	3	40			1,00	top coating
SDL0015	in rectangle	3	40			1,50	top coating

Cutters / milling tools to reach a smooth bevel

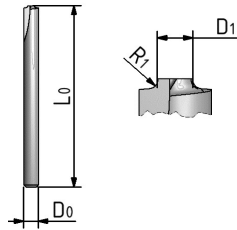

		D0	L0	R1	D1 Cutting-Ø	Material
SDI0009	Milling tools specially designed to sleek and finish	3	40	0,3	0,90	TC + AlTiCrN
SDI0010	the edge of the channel. An 0.3 mm radius will be	3	40	0,3	1,00	TC + AlTiCrN
SDI0011	made, avoiding a shap border and cleaning/shaving	3	40	0,3	1,10	TC + AlTiCrN
SDI0012	at the same time the edge from the steel chips	3	40	0,3	1,20	TC + AlTiCrN
SDI0013		3	40	0,3	1,30	TC + AlTiCrN
SDI0014		3	40	0,3	1,40	TC + AlTiCrN
SDI0015		3	40	0,3	1,50	TC + AlTiCrN
SDI0016		3	40	0,3	1,60	TC + AlTiCrN
SDI0017		3	40	0,3	1,70	TC + AlTiCrN
SDI0018		3	40	0,3	1,80	TC + AlTiCrN

Cutters / milling tools to engage a chanfer on the border of the channel on Steel Counter Plates. Using i.e an 90° Chanfering, you would get a 45° chanfer at the edge of the channel



Art.#	Description	D0	L0	L1	W1	D1 Head-Ø	Material
SDJ0340	Burring / chanfering tool	3	40		40°	3,00	AlTiN-S
SDJ0342	DLC - Diamond like Carbon cutter	3	40		40°	3,00	TC + DLC
SDJ0360		3	40		60°	3,00	AlCrN
SDJ0361	For chanfering channels of > 2,1 mm	3	38		60°	3,00	AlCrN
SDJ0362	DLC - Diamond like Carbon cutter	3	40		60°	3,00	TC + DLC
SDJ0390		3	40		90°	3,00	AlCrN
SDJ0392	DLC - Diamond like Carbon cutter	3	40		90°	3,00	TC + DLC
SDJ0540	Chanfering tool MOQ 10 pcs.	5	40		40°	5,00	AlTiN-S
SDJ0640		6	40		40°	6,00	AlTiN-S
SDJ0360		3	40		60°	3,00	AlTiN-S
SDJ0462	DLC - Diamond like Carbon cutter	4	40		60°	3,00	TC + DLC
SDJ0492	DLC - Diamond like Carbon cutter	4	40		90°	3,00	TC + DLC
SDJ0660		6	40		60°	6,00	AlTiN-S
SDJ0692	DLC - Diamond like Carbon cutter	6	50		90°	6,00	TC + DLC
SDJ6122	DLC - For chanfering Pertinax with 120°	6	50		120°	6,00	TC + DLC
SDJ6162	DLC - For chanfering Pertinax with 160°	6	50		160°	6,00	TC + DLC

Cutter / milling tools for cutting pockets on steel plates up to 52 HRC hardness (To create a gap in which the patrice embossing tools and/or the reverse scoring knives can be placed. Usually with a depth of recess of 0.40 - 0.55 mm)

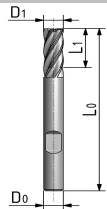

Art.#	Description	D0	L0	L1	W1	D1 Head-Ø	Material
SDB0001	Cutter / milling tool with 5 edges for cutting pockets	6	40	13		6,00	TC + AlCrN
SDB0002	A tool which allow to mill on steps of 0.15 mm	6	50	13		6,00	TC+ AlCrN
NEW	SDB0003 Cutter with 3 edges	5	40			5,00	TC+ DLC
NEW	SDB0005 Cutter with 4 edges	4	50			4,00	AlTiN
	SDB0006 Cutter with 4 edges	6	58			5,00	AlTiNCrN

Other types and sizes available upon request
 Most cutter for delivery within 24 hours
 Prices based EXW Germany
 Collets / adapter for different shank-diameters available

Hardening:

TC : Tungsten Carbide
 TiAlN : Titanium Aluminium Nitride
 AlCrN: Aluminium Chromium Nitride
 AlTiNCrN: Multilayered coating
 DLC : Diamond like Carbon